

ANYTIME AK-01 for Android App Manual

ANYTIME AK-01 App is an app for remotely operating the silent piano "ANYTIME AK-01" from the Android.

Describes how to operate the App.

1. How to connect

Connect the AK-01 control box and the Android via Bluetooth.

Before connecting via Bluetooth, you need to change the Android's Bluetooth settings.

Set as follows from "Settings" on the apps screen.

Step 1

Tap "Settings" from the apps.

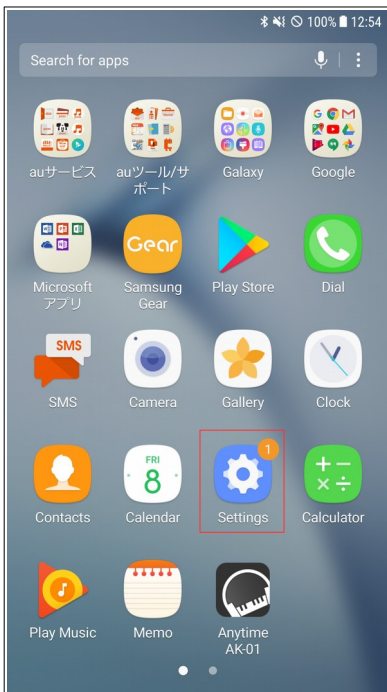

Step 2

Tap "Connections" from the settings.

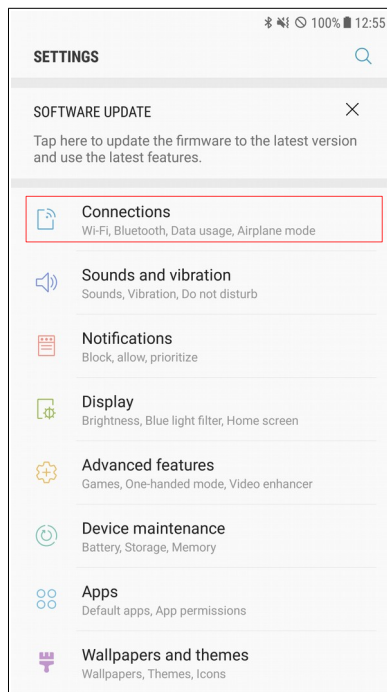

Step 3

Set Bluetooth to "On".

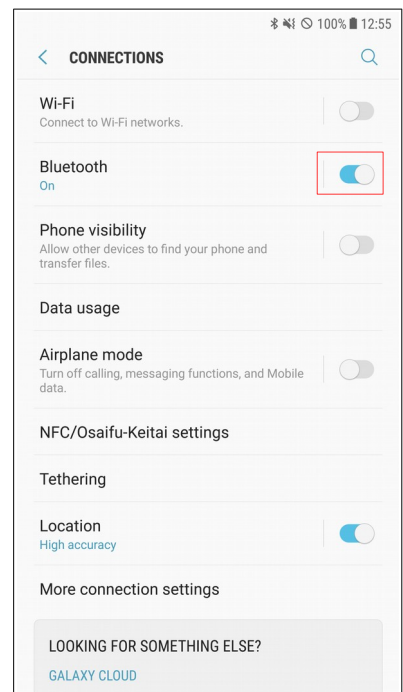

You can also change the Bluetooth setting to "On" from the Quick Settings panel, as shown below.

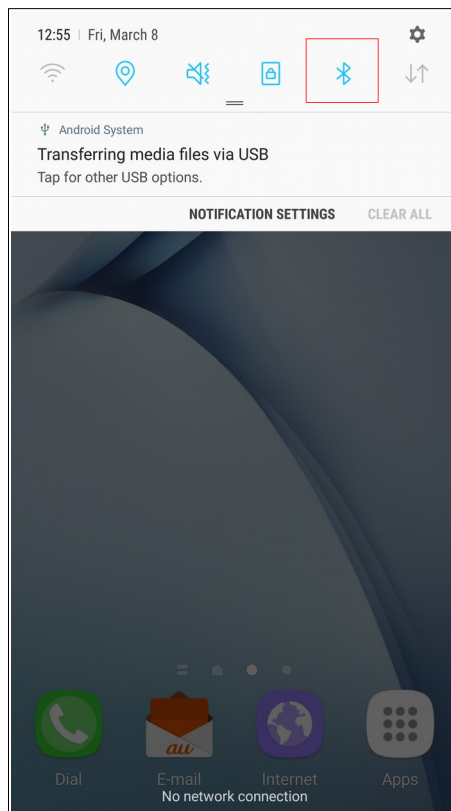

2. Launch App

From the apps screen, tap the "Anytime AK-01" icon.

The ANYTIME AK-01 App starts and the sound screen is displayed.

Step 1

Tap "Anytime AK-01" from the apps screen.

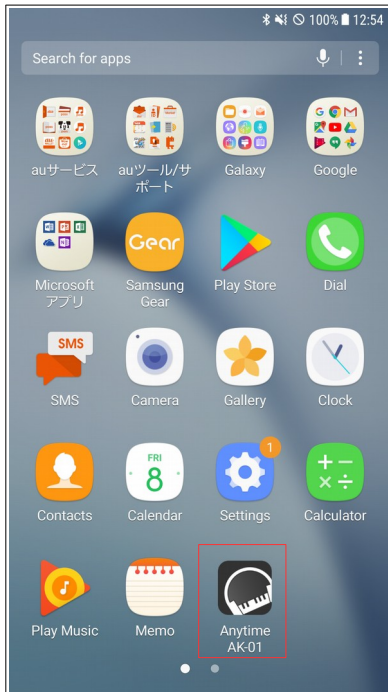

Step 2

The app launches and the sound screen is displayed.

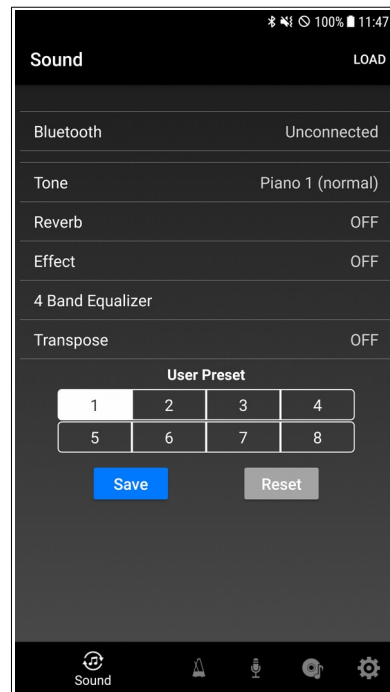

[NOTE]

The following dialog is displayed when launching App for the first time immediately after installation. ANYTIME AK-01 does not use location information, but with Android 6.0 or later devices, you need to allow access to location information when using Bluetooth, so tap "ALLOW".

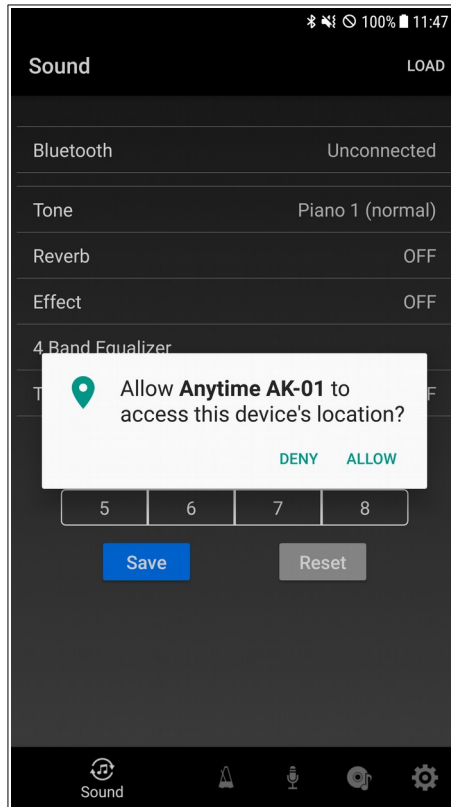

3. Basic operation

When the app is launched for the first time, the sound screen is displayed.

There are 5 tabs at the bottom of the screen to switch between sound, metronome, recording / playback, demo song, and adjustment.

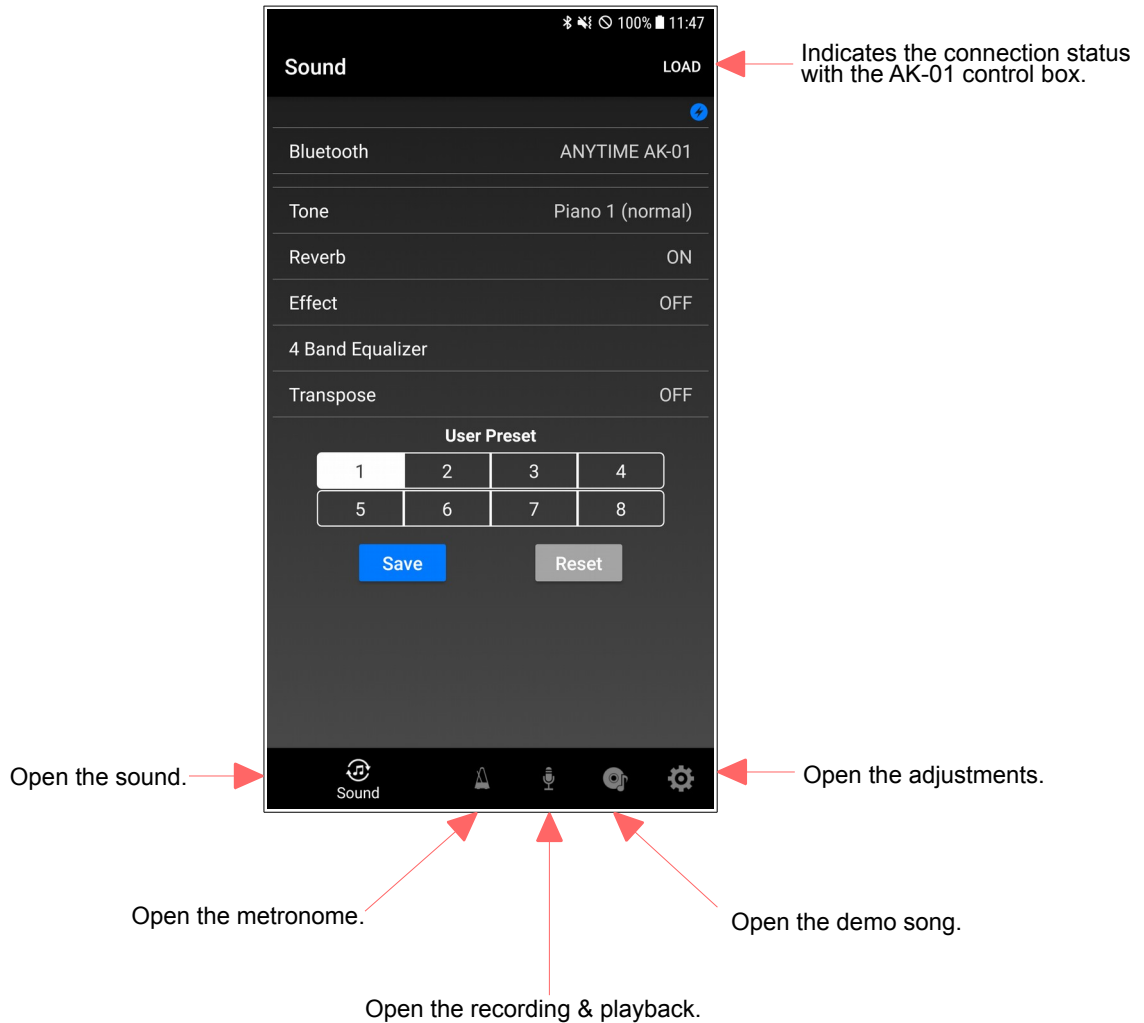

[NOTE]

The blue circle icon at the top of the screen indicates the Bluetooth connection with the AK-01 control box, and when this icon is displayed, it indicates that the connection with the AK-01 control box is in progress. When this icon disappears, it indicates that the AK-01 control box can not be connected, and in this state, you can not operate the AK-01 control box from the App.

This icon is displayed on all screens.

4. Sound

Configure Bluetooth settings for connecting to the AK-01 control box, and settings related to sounds such as timbre and reverb.

First tap "Bluetooth" to connect with the AK-01 control box. When connection is completed, the sound status is loaded to the App, and the AK-01 control box and the sound settings are synchronized.

The sound can be set to five types of tone, reverb, effects, 4-band equalizer, and transpose, but the combination of each setting can be saved in eight user presets. You can switch to your preferred settings with one touch.

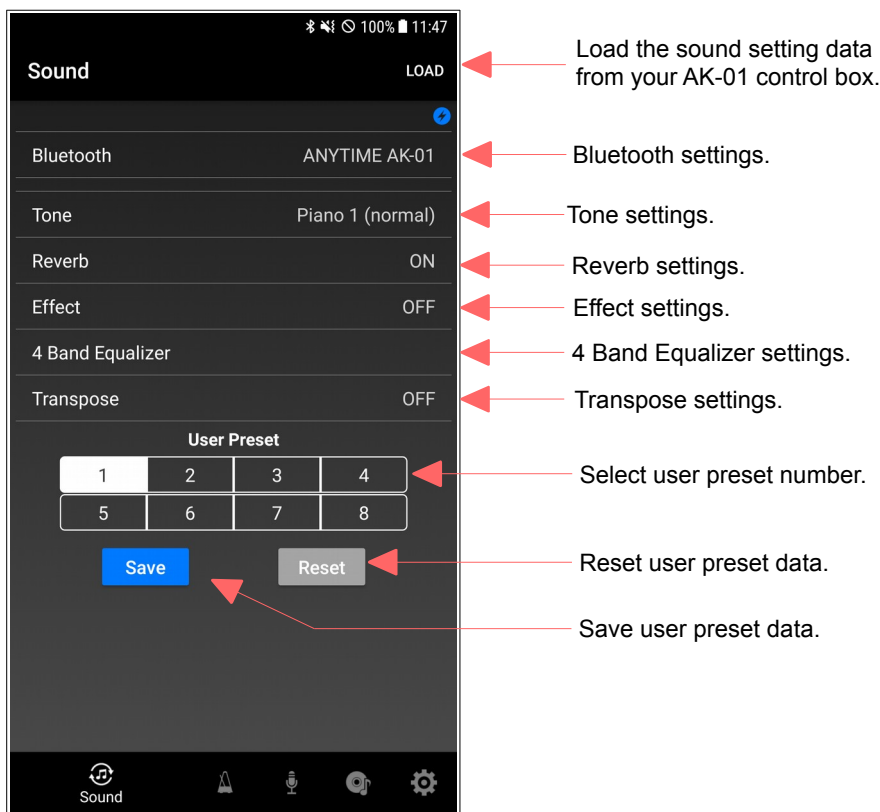

4.1. Bluetooth

Set Bluetooth and connect with AK-01 control box.

Turn on the power of the AK-01 control box, and connect according to the following procedure.

Step 1

Tap "Bluetooth" to display a list of Bluetooth MIDI devices.

Step 2

Tap "ANYTIME AK-01" to start connection. The status will be "Connecting".

Step 3

The connection is complete when the status changes to "connected".

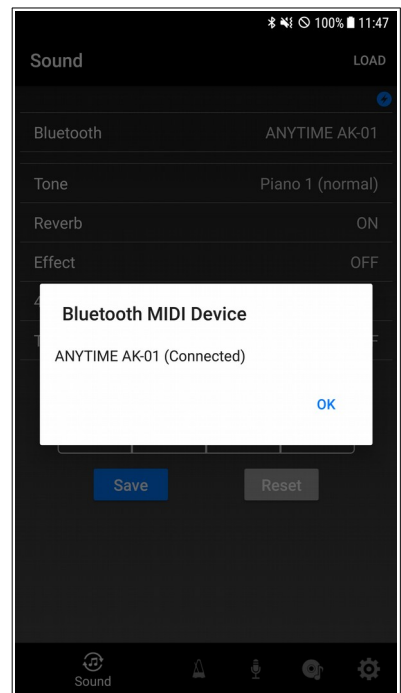
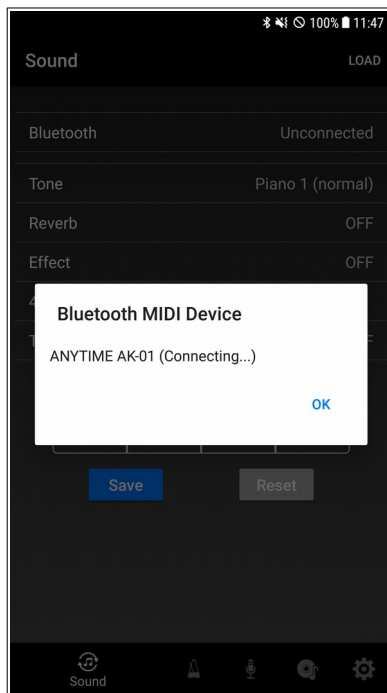
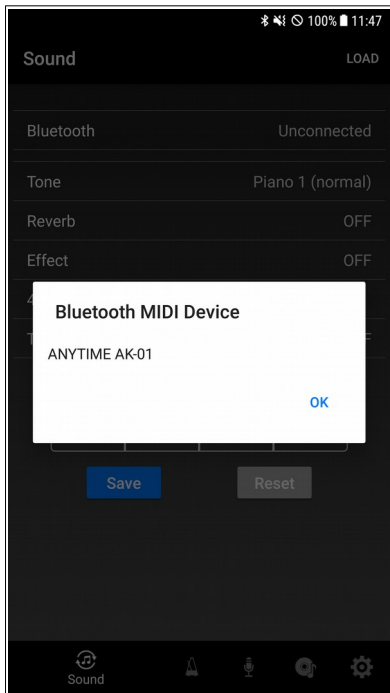

[NOTE]

In the connected state, tapping "ANYTIME AK-01" disconnects the connection with the AK-01 control box. However, when turning off the power of the AK-01 control box, it is not necessary to disconnect this screen.

4.2. Tone

Select the tone.

You can select from 128 different tones.

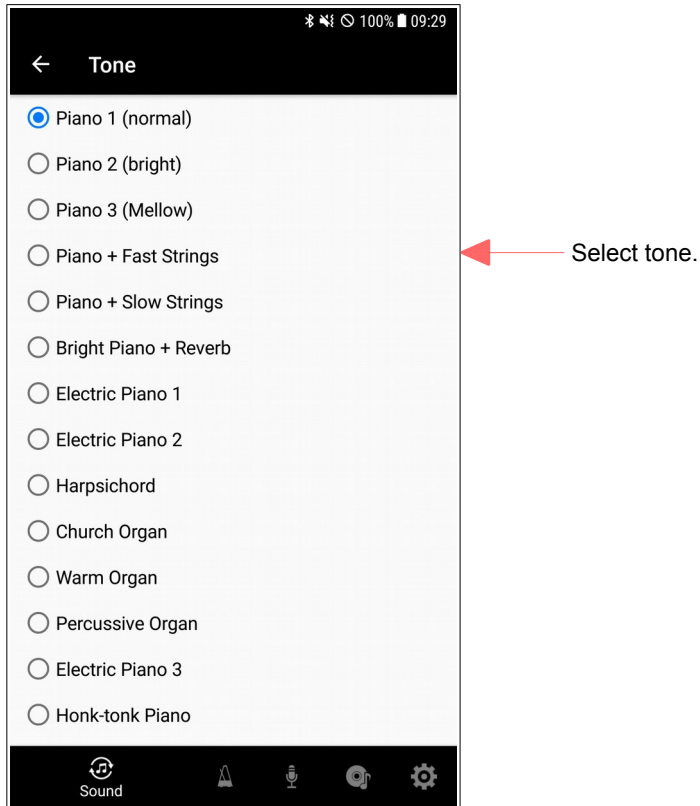

[NOTE]

The tone changes apply to the currently selected user preset, but if you want to save the changes, return to the sound screen and save the user preset.

4.3. Reverb

Set the reverb.

Chose from either Room or Hall reverb and customize its depth.

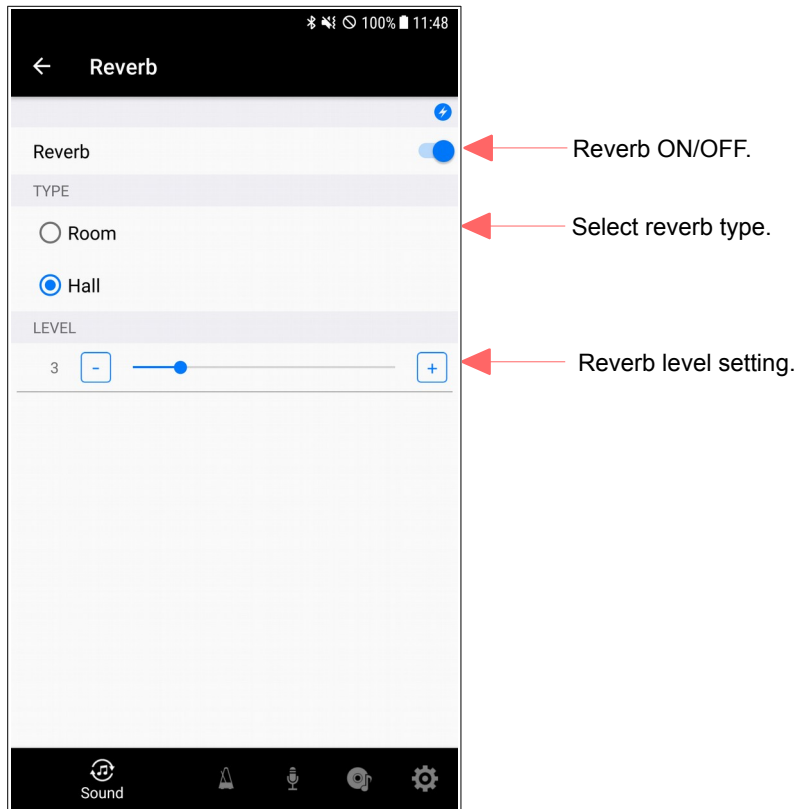

[NOTE]

The reverb changes apply to the currently selected user preset, but if you want to save the changes, return to the sound screen and save the user preset.

4.4. Effect

Set the effect.

Choose from either Chorus, Rotary speaker, or Delay effects. The level cannot be adjusted when the rotary effect is selected.

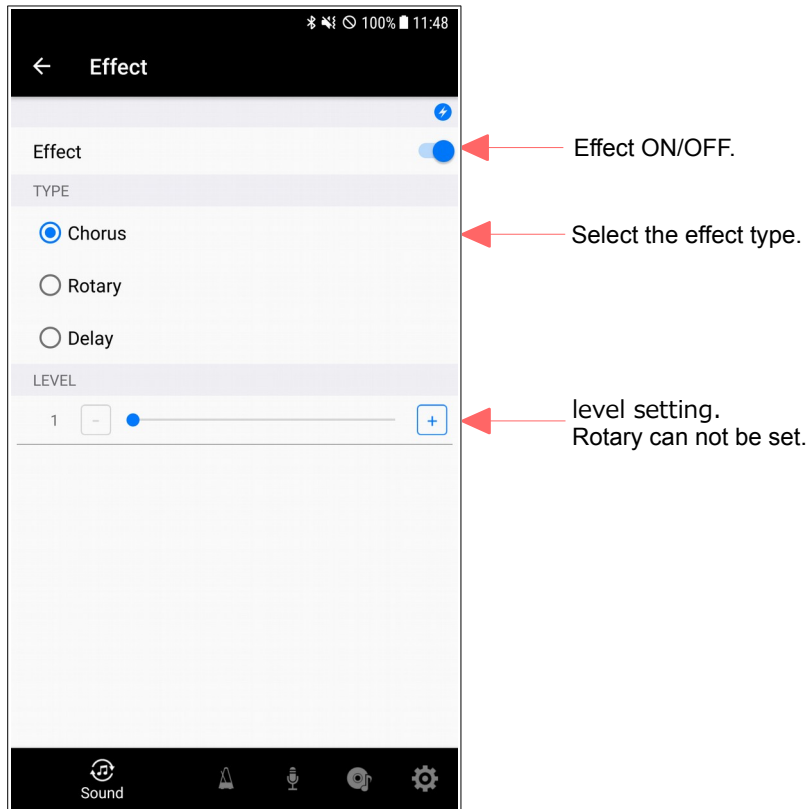

[NOTE]

The effect changes apply to the currently selected user preset, but if you want to save the changes, return to the sound screen and save the user preset.

4.5. 4 Band Equalizer

Set the 4 band equalizer.

Three preset patterns and user settings are possible.

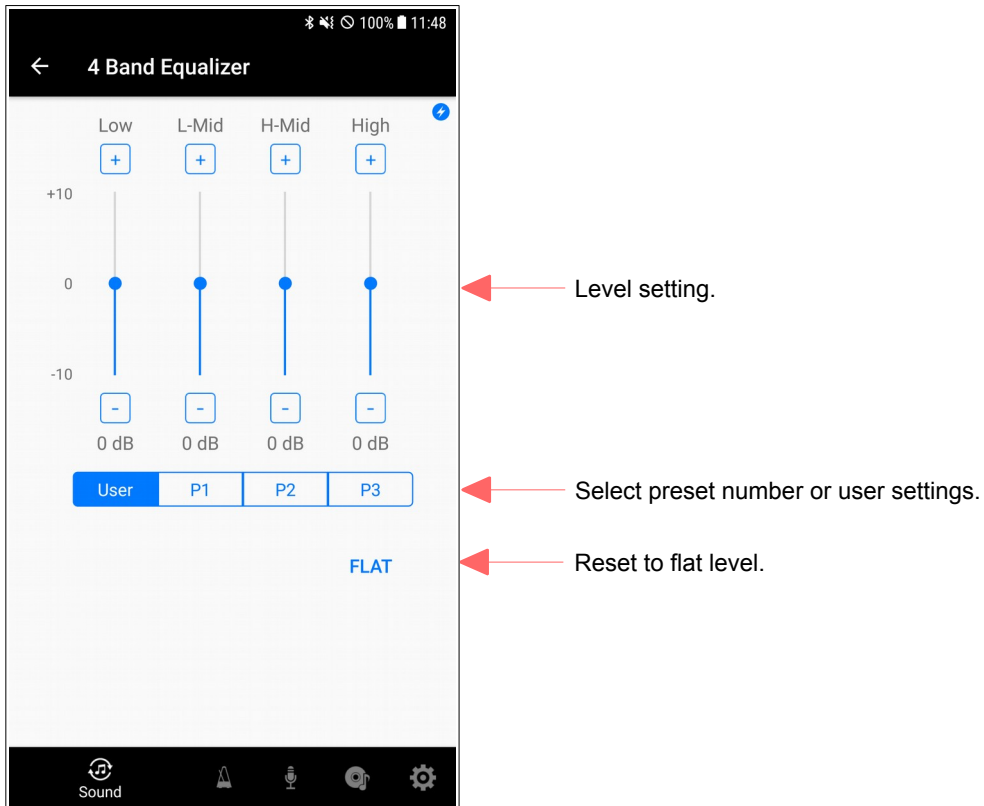

[NOTE]

The 4 band equalizer changes apply to the currently selected user preset, but if you want to save the changes, return to the sound screen and save the user preset.

4.6. Transpose

Set the transpose.

Note: it is possible to transpose by +/- 2 octaves.

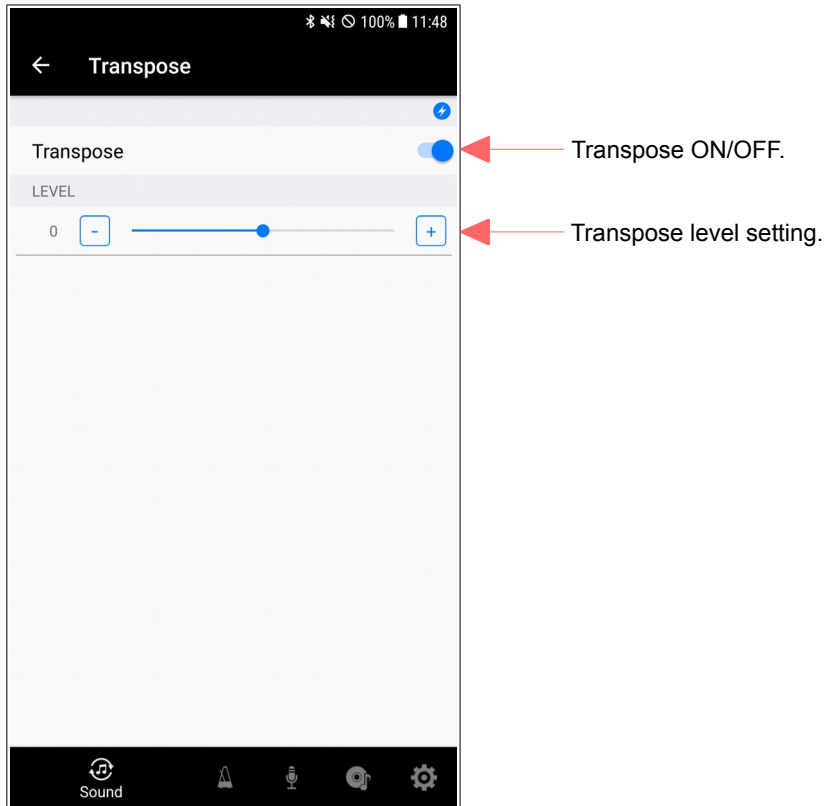

[NOTE]

The transpose changes apply to the currently selected user preset, but if you want to save the changes, return to the sound screen and save the user preset.

5. Metronome

The metronome can be customized with the following settings:

- Beat: None, 2, 3, 4, 5, 6, 8
- Tempo: 30 - 250
- Volume: 12 levels

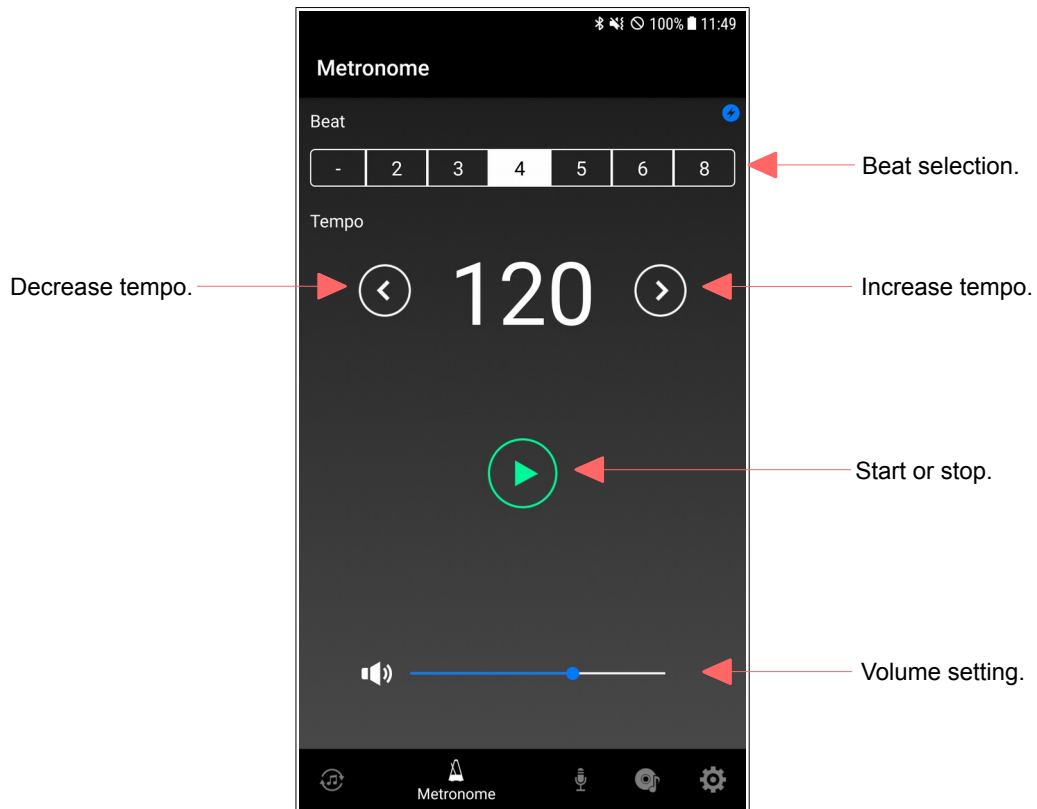

6. Recording & Playback

Control performance data recording and playback on this screen.

You can send the performance data saved on your AK-01 control box to your Android, as well as send new performance data from your Android and play it back on your AK-01 control box. It is also possible to email your performance data from this screen. Note that you will need to set up an email account beforehand.

During playback, playback speed and volume is variable.

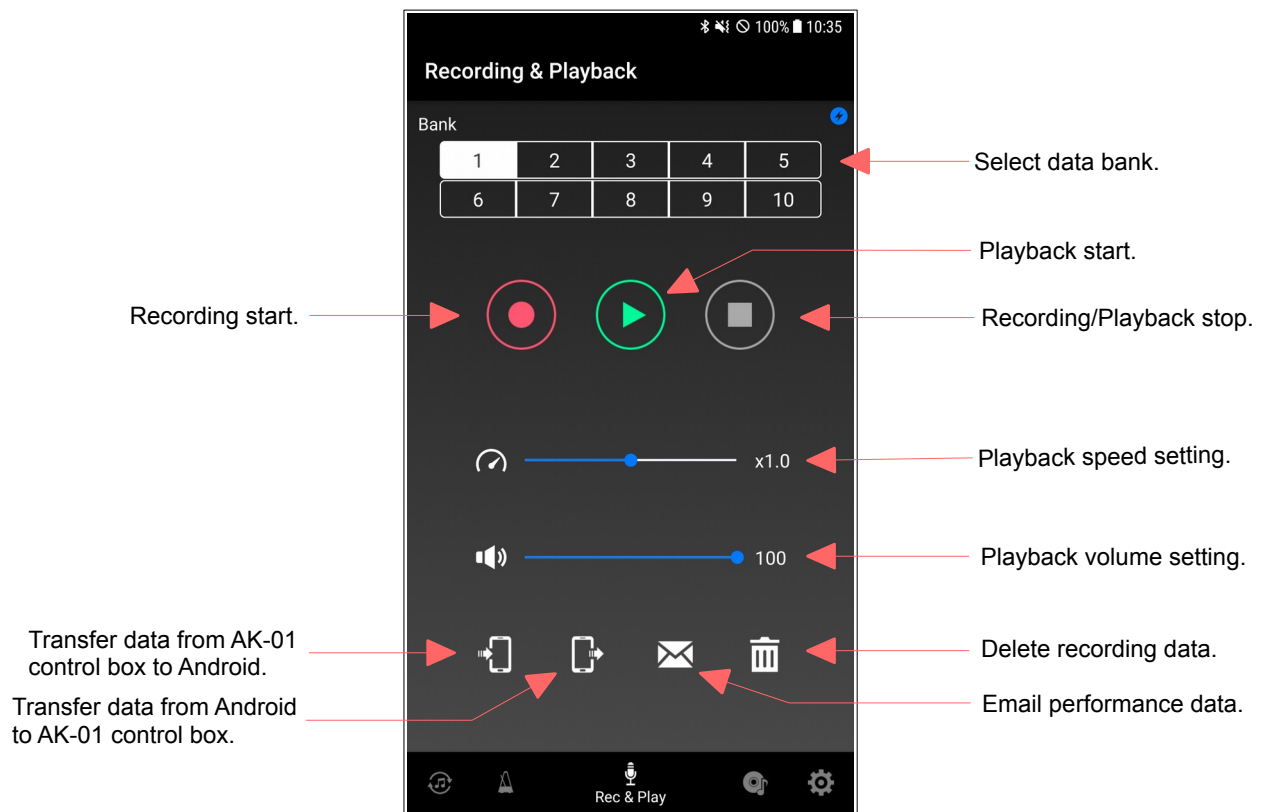

[NOTE]

The following dialog is displayed when you select the Record / Play screen for the first time after installing the app. Please tap "ALLOW" in order to save and read recorded data on Android device with ANYTIME AK-01.

There is no access to data on Android devices other than recorded data.

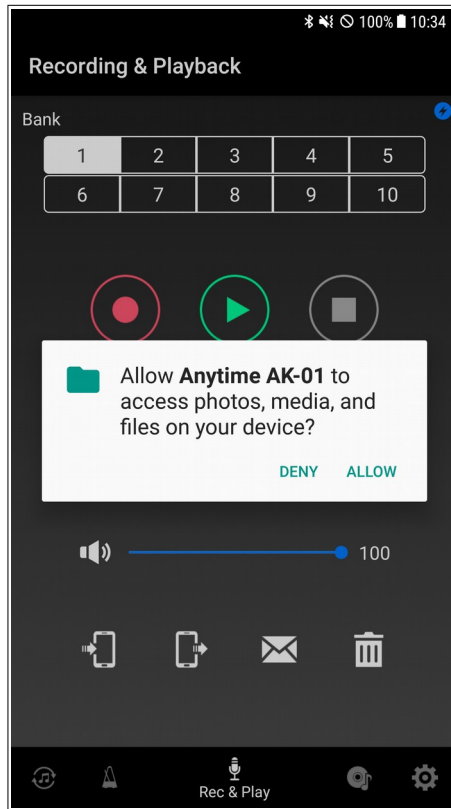

6.1. Recording of performance data

Record performance data on the AK-01 control box.

You can save up to 10 songs of recorded data to the AK-01 control box by selecting a bank.

Follow the steps below to recording.

Step 1

Select the recording destination bank of the AK-01 control box.

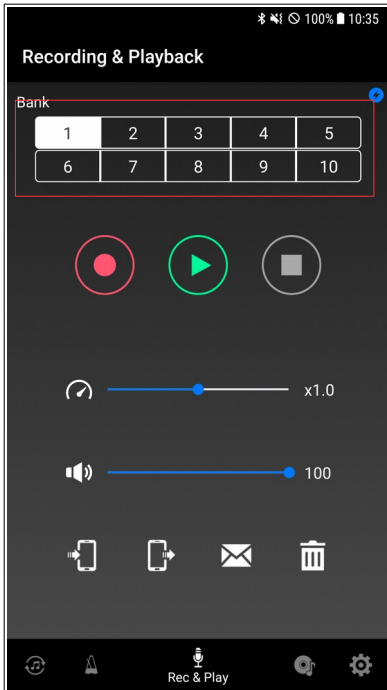

Step 2

Tap the Record button to begin playing on the piano.

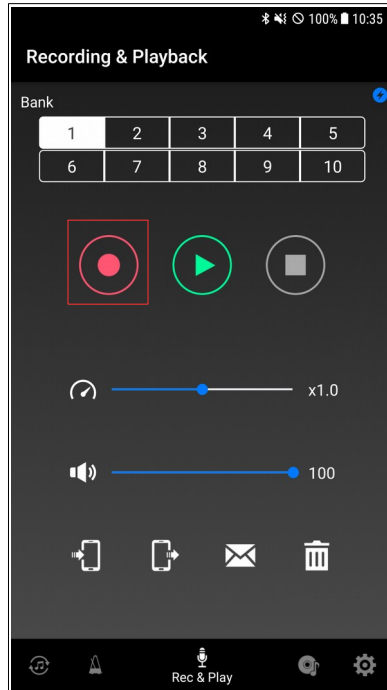

Step 3

If you want to stop recording, tap the stop button.



6.2. Playback of recorded data

Playback the performance data recorded on the AK-01 control box. Follow the steps below to playback.

Step 1

Select the bank you want to play.

Step 2

Tap the play button.

Step 3

If you want to stop playback, tap the stop button.

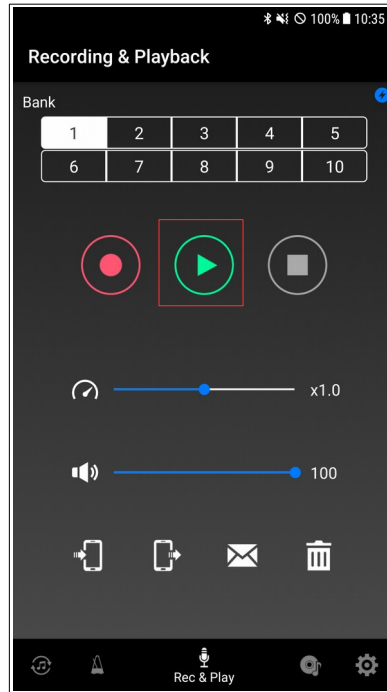
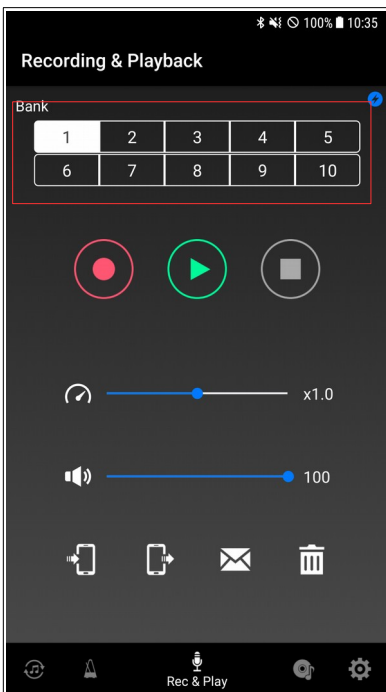

During playback, the speed slider allows you to change the playback speed (0.5-2.0 times). You can also change the playback volume with the speaker slider (10 levels).

6.3. Transfer of recorded data from AK-01 control box to Android

You can transfer recording data saved in AK-01 control box to Android.

You can only save up to 10 songs on the AK-01 control box, but you can save more recorded data by transferring it to the Android.

Follow the steps below to transfer.

Step 1

Select the bank to transfer.

Step 2

Tap the Transfer button from AK-01 control box to Android.

Step 3

Enter a file name to manage on Android, and tap "OK".

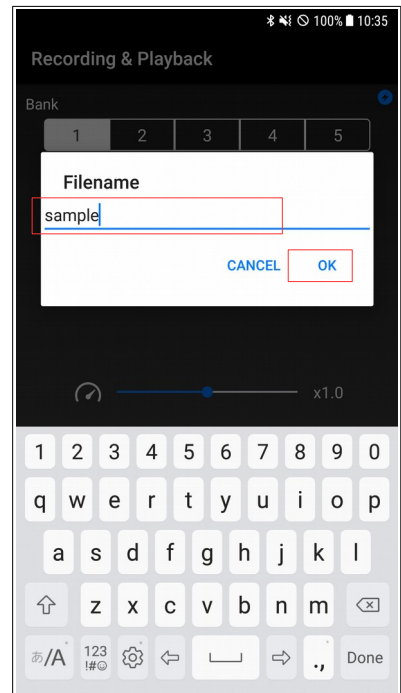
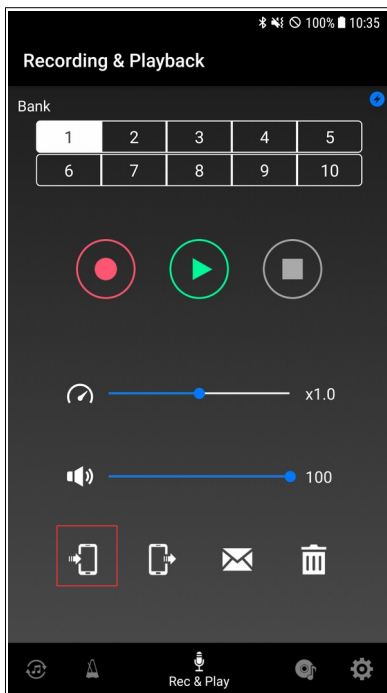
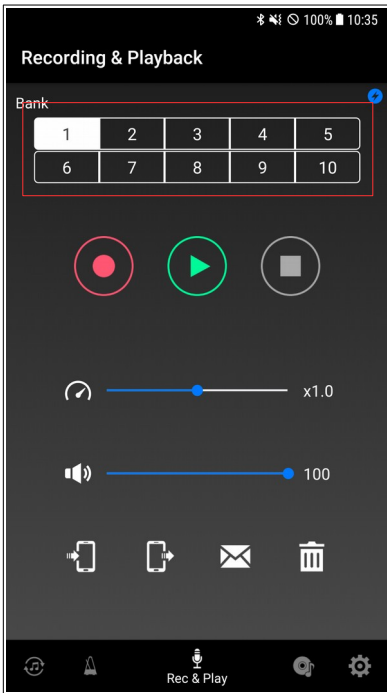

Step 4

During data transfer, the following dialog is displayed to show the status of transfer.

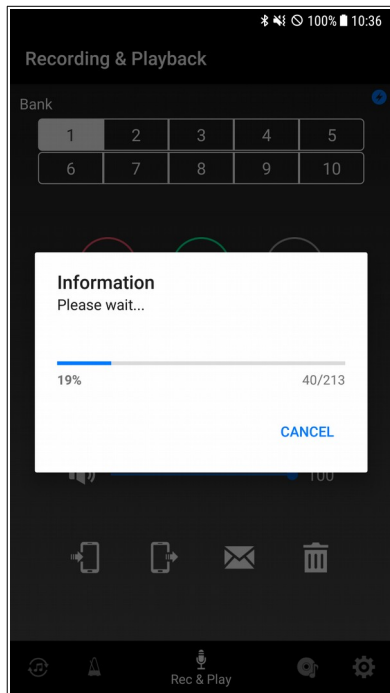

Step 5

The dialog disappears when the transfer is complete.

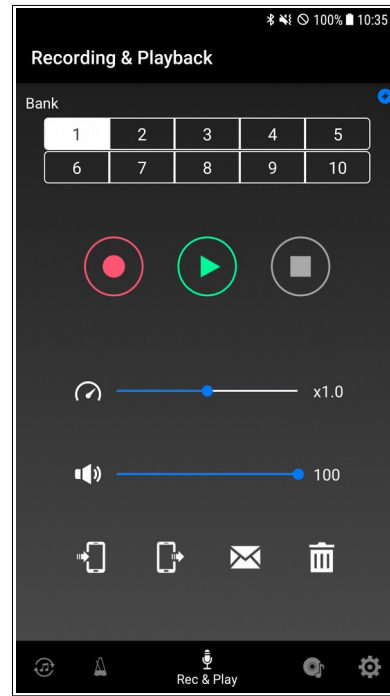

6.4. Transfer of recorded data from Android to AK-01 control box

You can transfer the recorded data saved on the Android to the AK-01 control box. Follow the steps below to transfer.

Step 1

Tap the transfer destination bank.

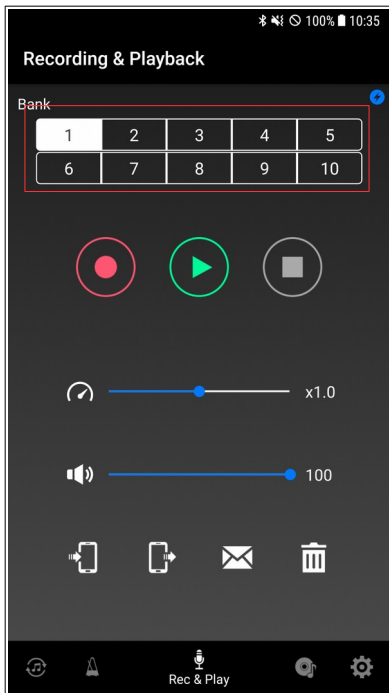

Step 2

Tap the Transfer button from Android to AK-01 control box.

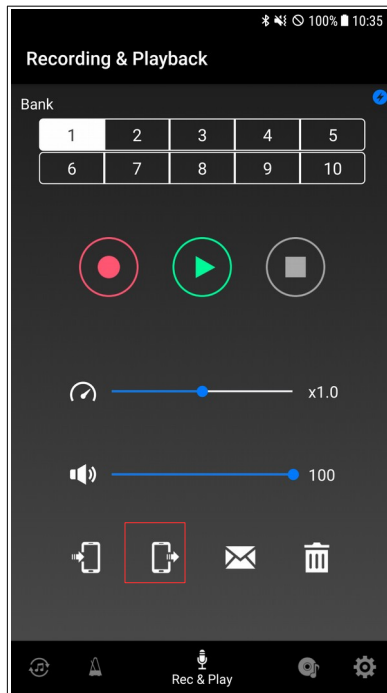

Step 3

Select the file of recorded data on Android, and tap "OK".

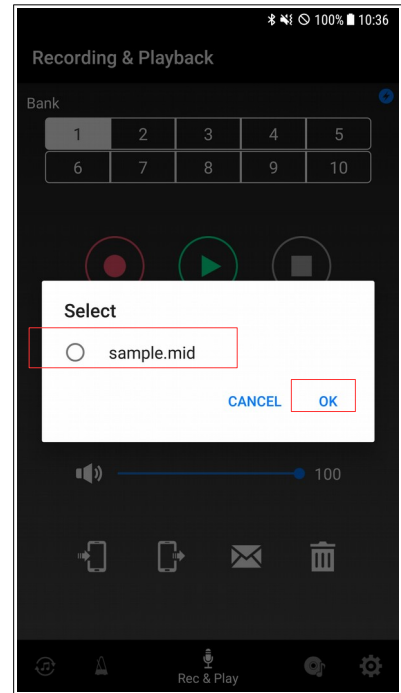

Step 4

During data transfer, the following dialog is displayed to show the status of transfer.

Step 5

The dialog disappears when the transfer is complete.

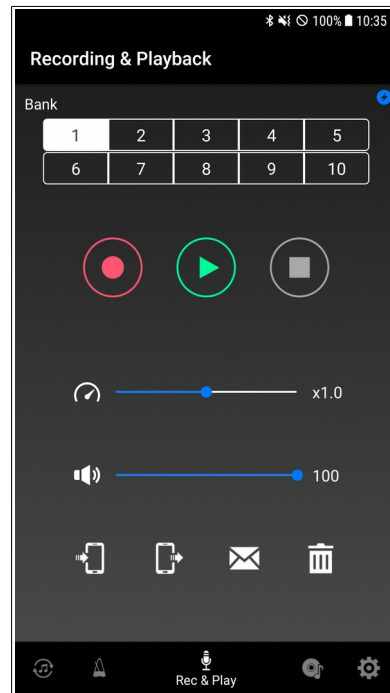
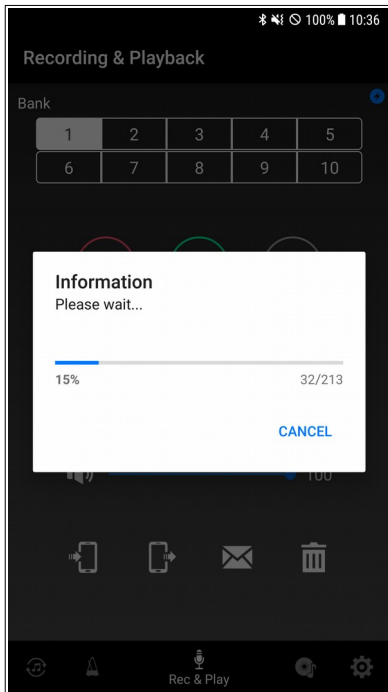

6.5. Sending recording data by email

You can send the recorded data saved on Android as an email attachment. Follow the steps below to send.

Step 1

Tap the mail button.

Step 2

Select the file name of the recorded data on Android and tap "OK".

Step 3

The email will be launched and automatically added to the attached file. Please enter the required items and send the email.

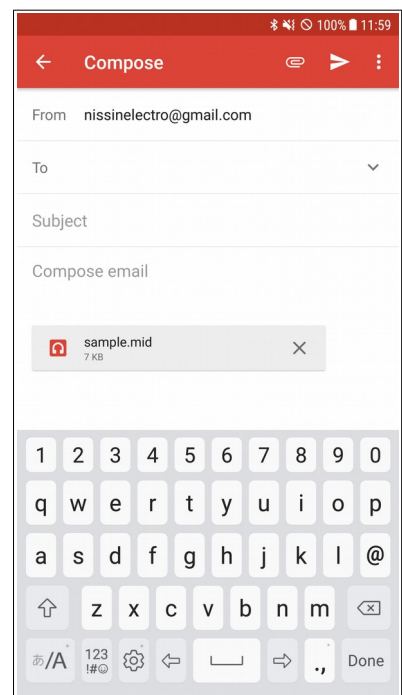
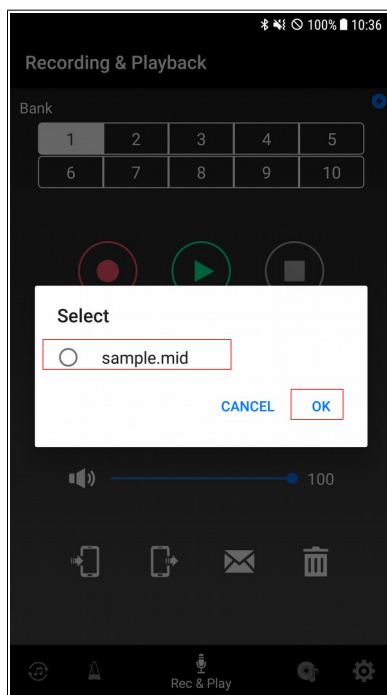
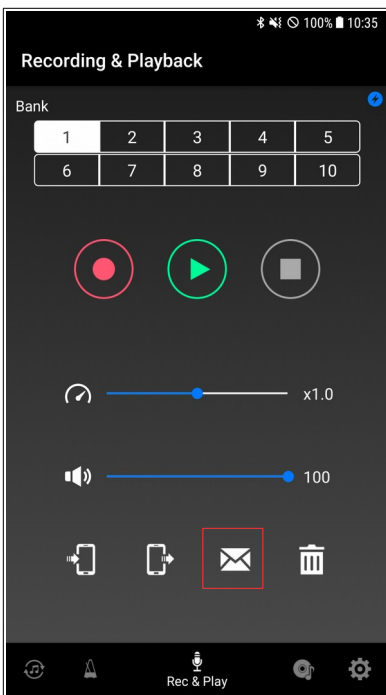

[NOTE]

You need to set up your email account before using email. Please refer to your carrier's setting guide etc. for setting email.

6.6. Copy of recorded data received by email

When transferring recording data from Android to AK-01 control box, the App accesses the download folder, so please copy the recording data received by email to the download folder.

In Gmail, open the received email and tap the download icon.

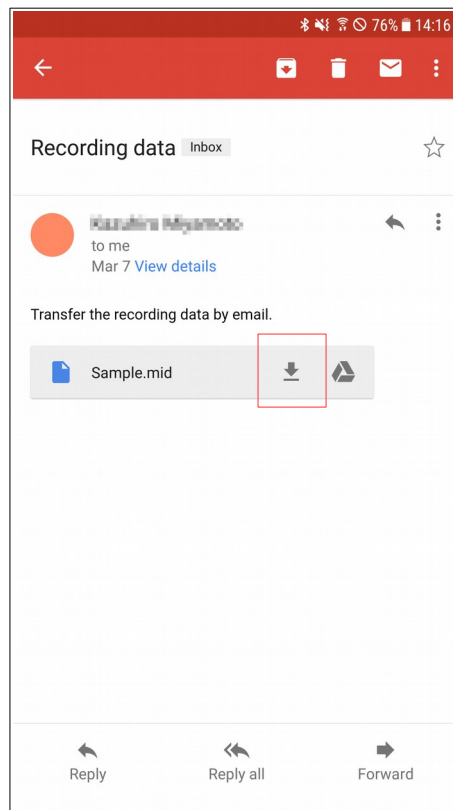

6.7. Delete recording data

Delete the recording data of the AK-01 control box.
Follow the steps below to delete.

Step 1

Select the bank you want to delete. Tap the delete button.

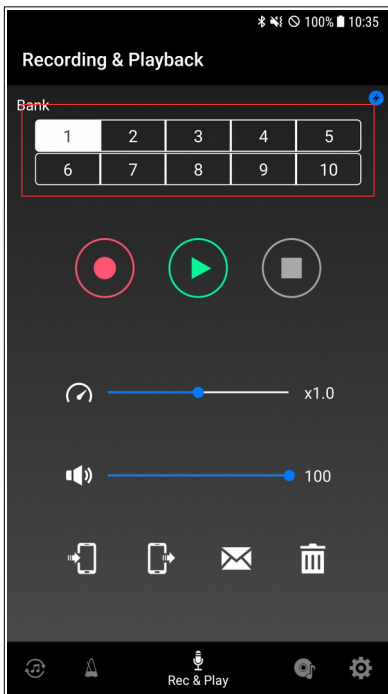

Step 2

Tap the delete button.

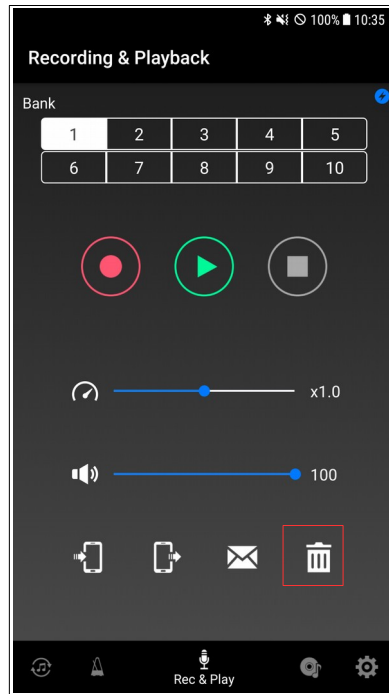

Step 3

Tap "Yes" to delete the recorded data.

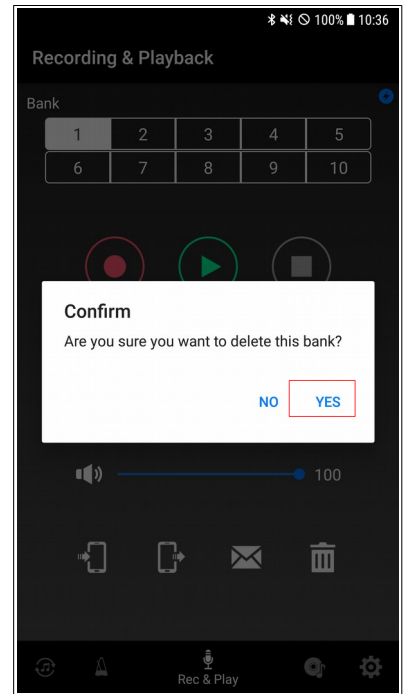

7. Demo Songs

Play demonstration songs.

Choose from 10 different demo songs that are stored on your AK-01 control box.

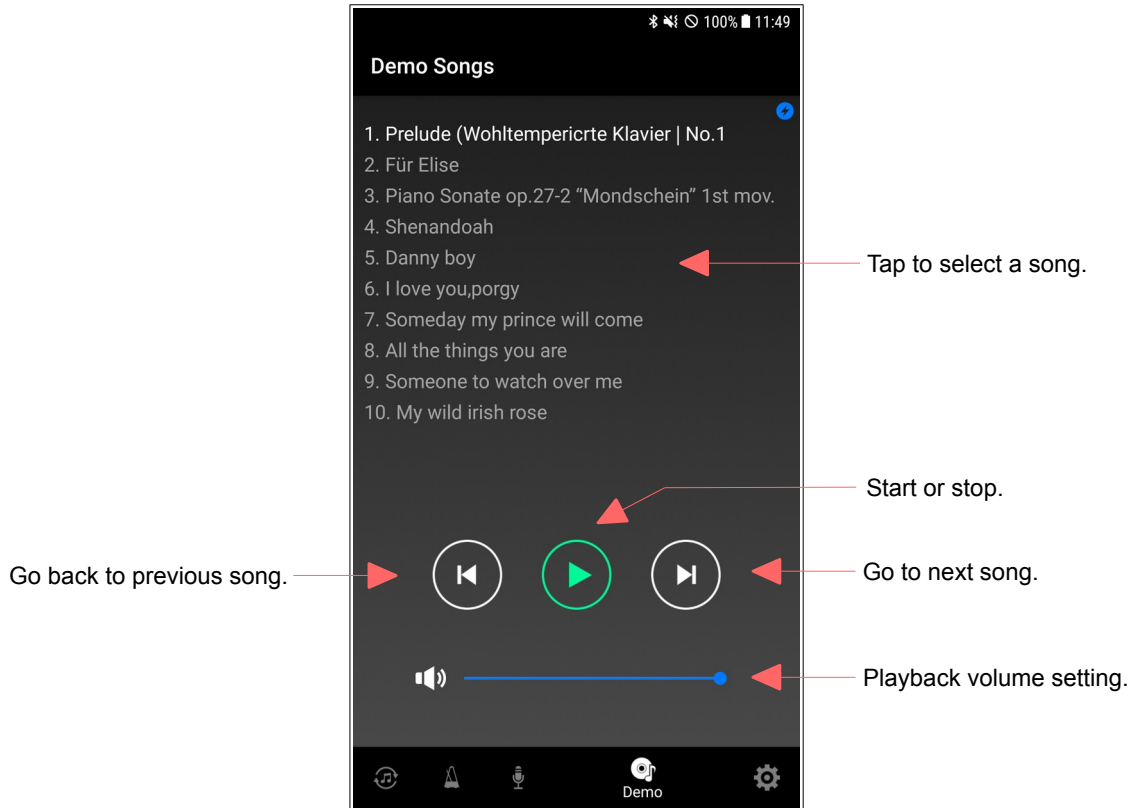

8. Adjustments

Adjust various functions of the AK-01 control box.

Adjust each item according to the condition of the piano with AK-01 attached. For adjustment contents of each adjustment item, refer to the instruction manual supplied with the AK-01 control box.

After connecting with the AK-01 control box, if you select the main unit adjustment, each adjustment value will be loaded automatically. This synchronizes the AK-01 control box with the main unit adjustment. You can also load manually by tapping the "Load" button.

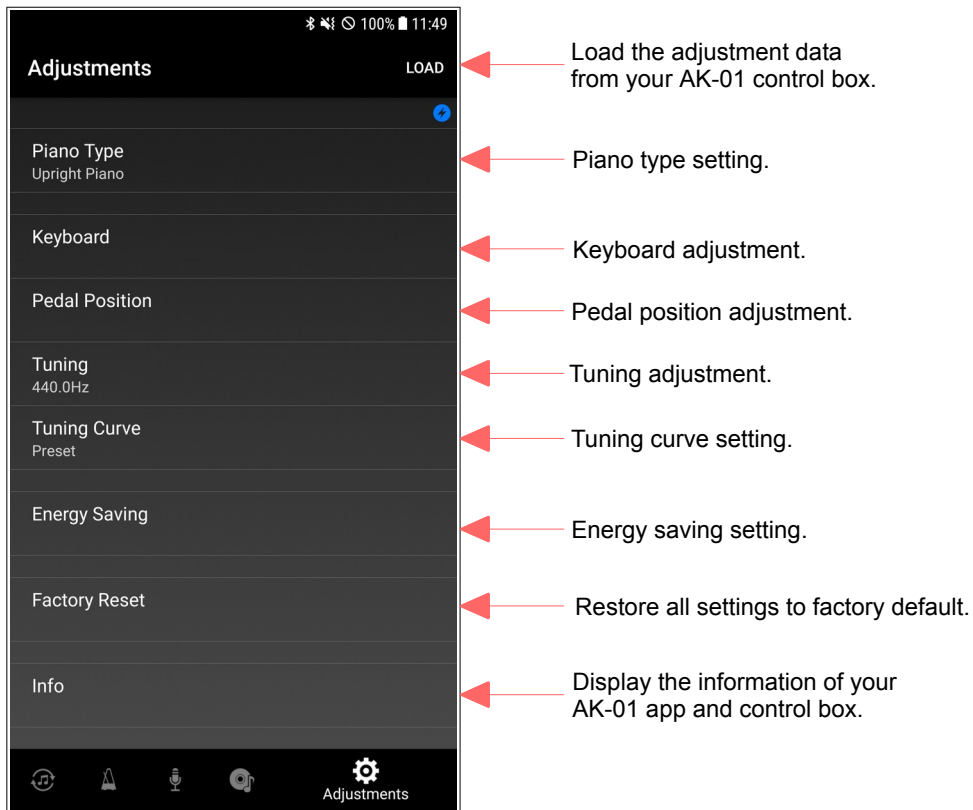

8.1. Piano Type

Adjust the piano type.

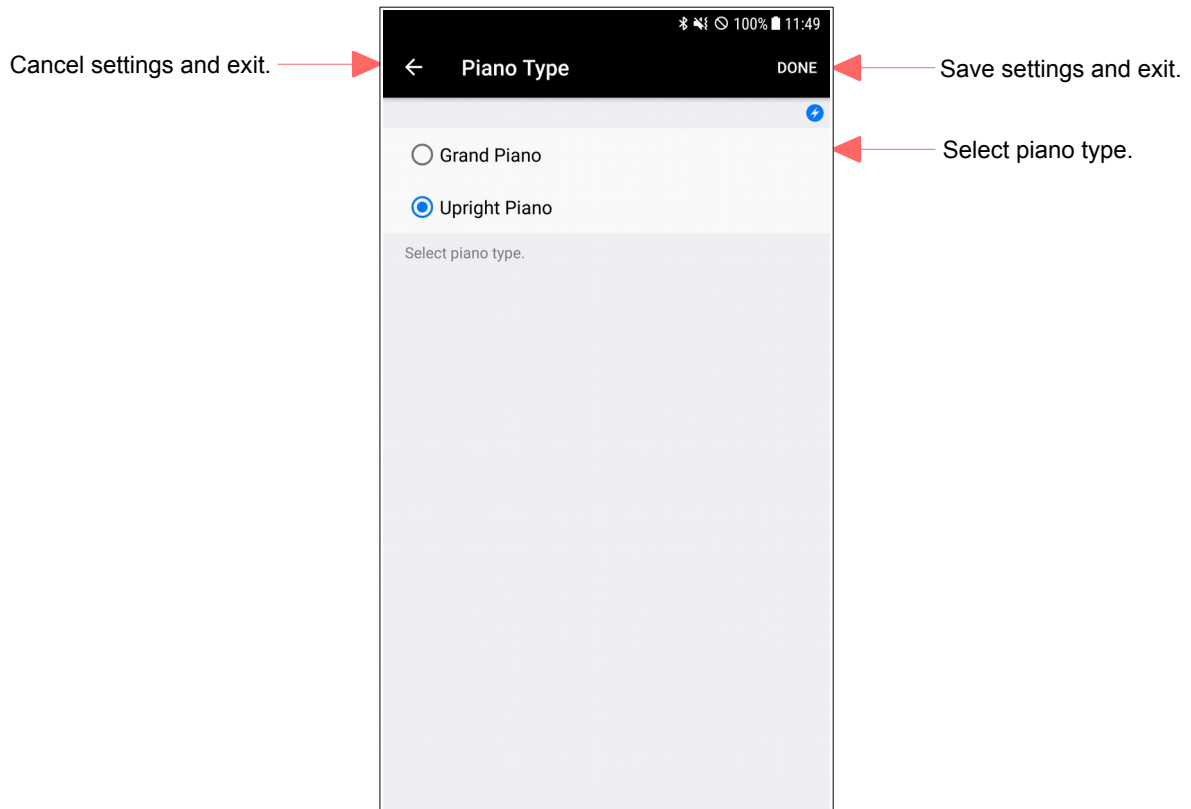

8.2. Keyboard

Displays the adjustment items related to the keyboard.

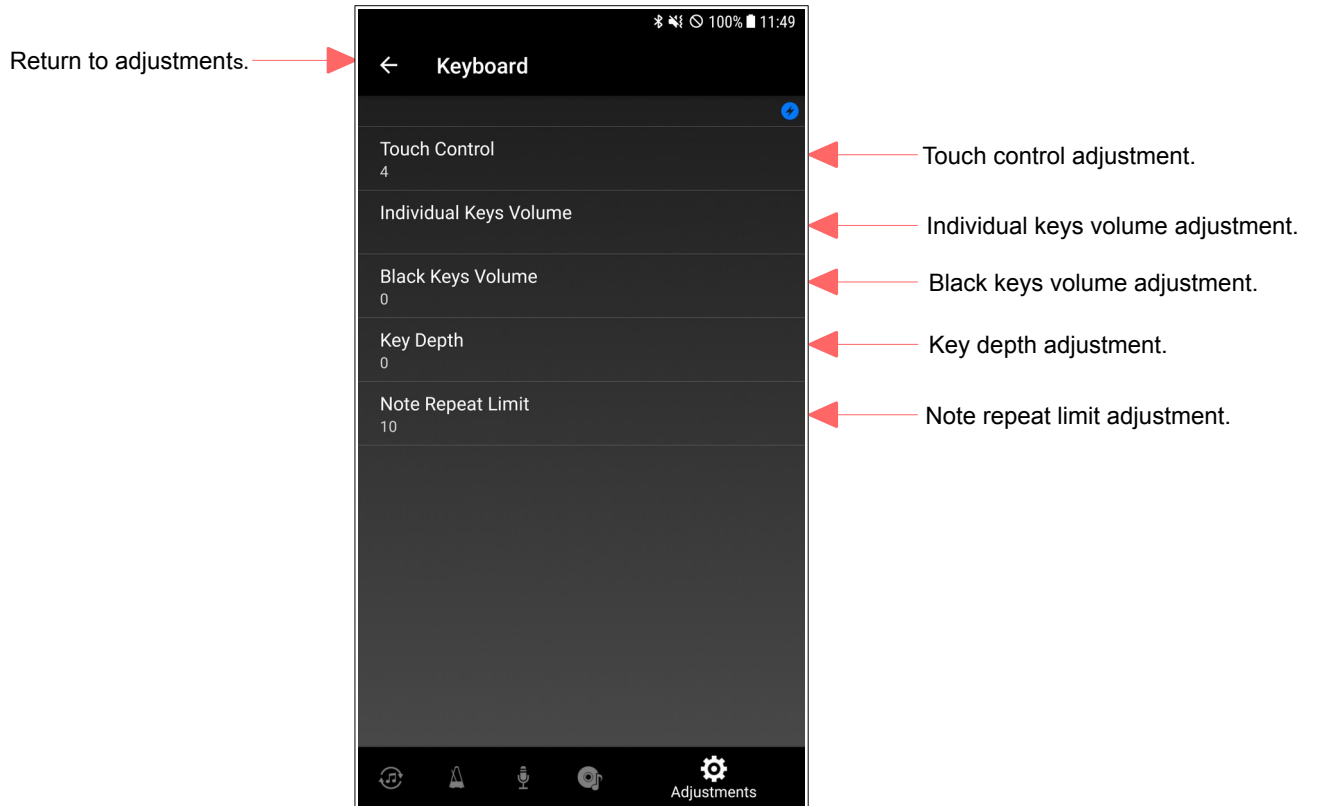

8.2.1. Touch Control

Adjust the key touch.

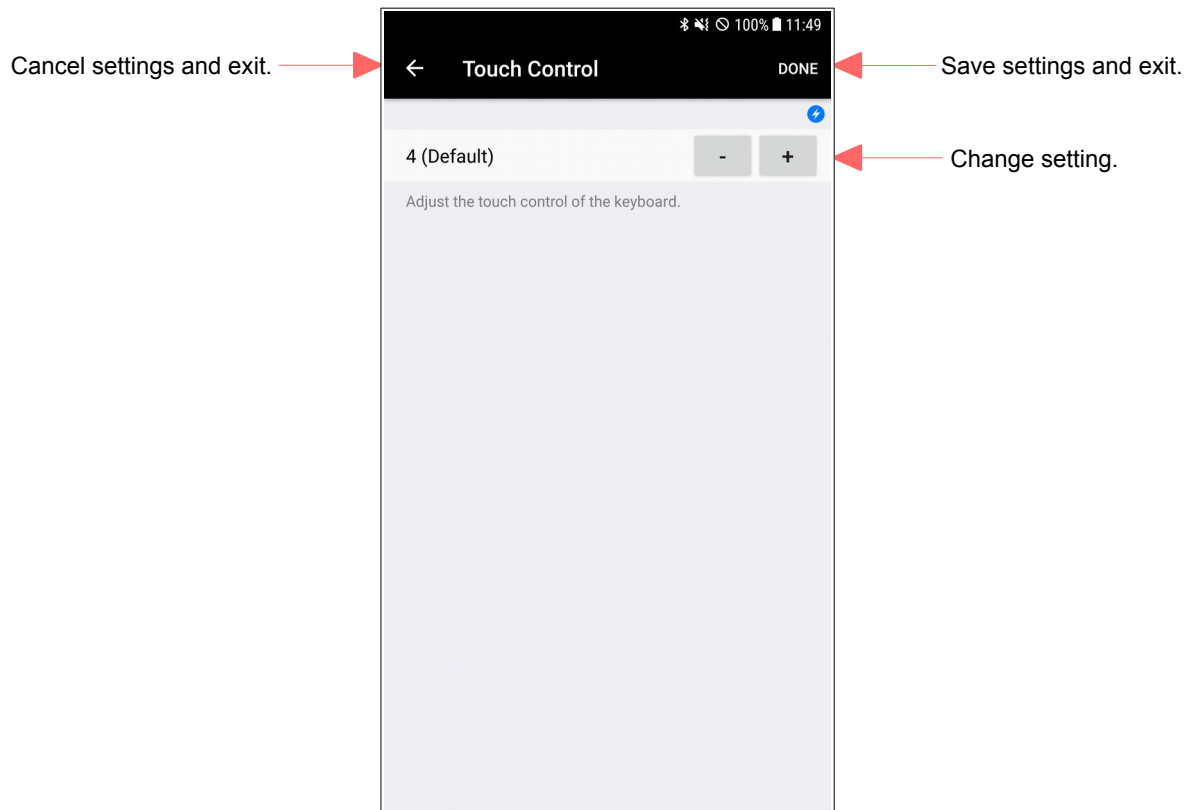

8.2.2. Individual Keys Volume

Adjust the volume for individual keys.

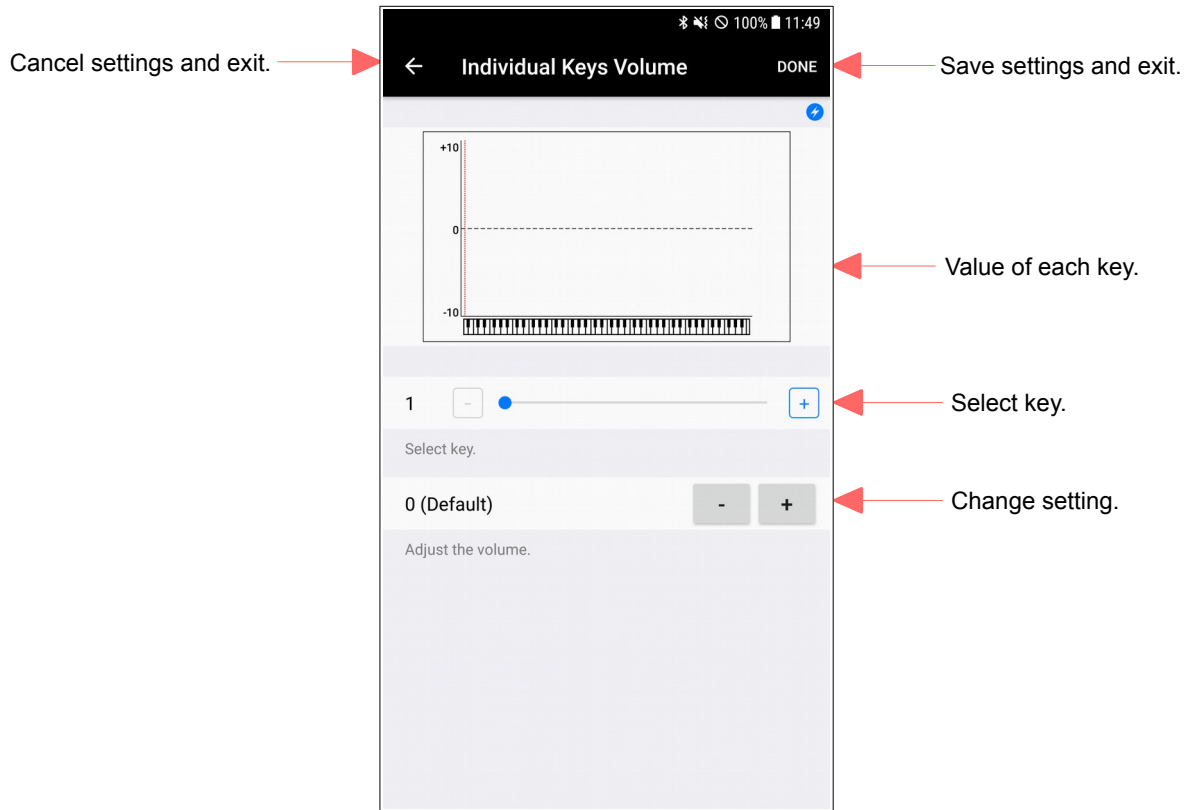

8.2.3. Black Keys Volume

Adjust the black keys volume.

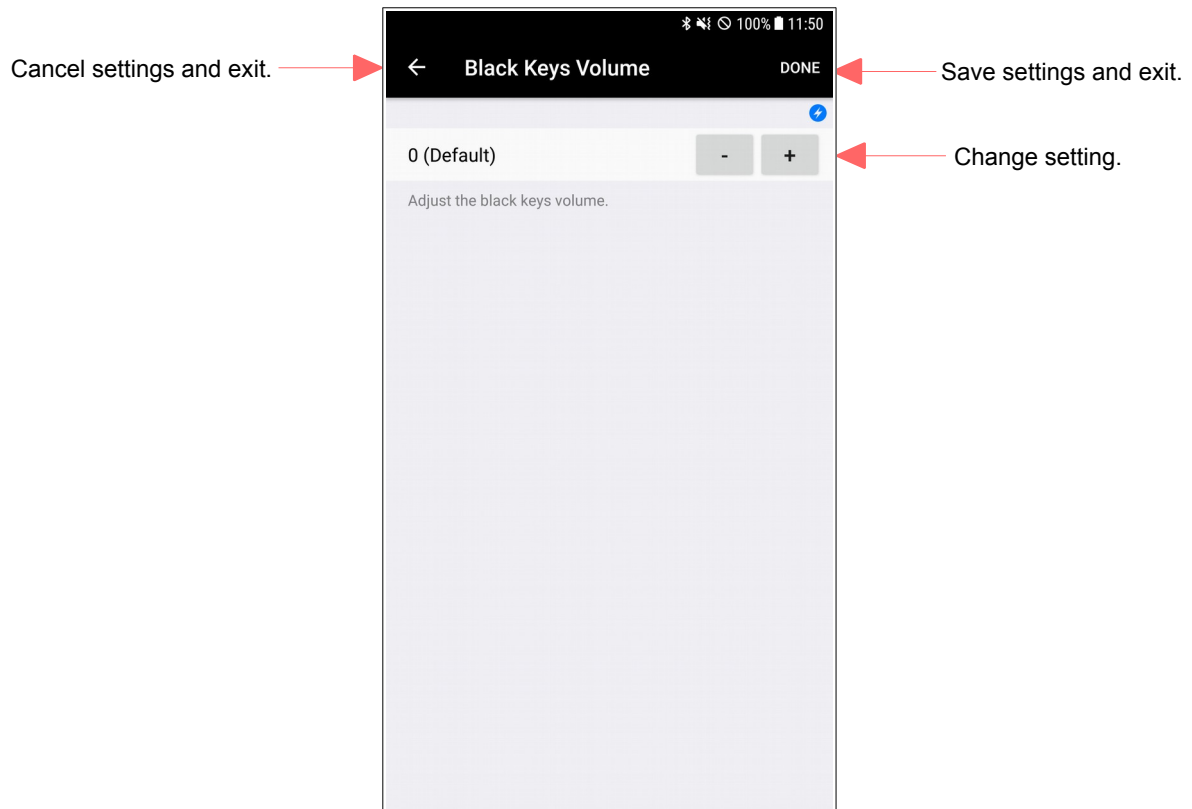

8.2.4. Key Depth

Adjust the key depth.

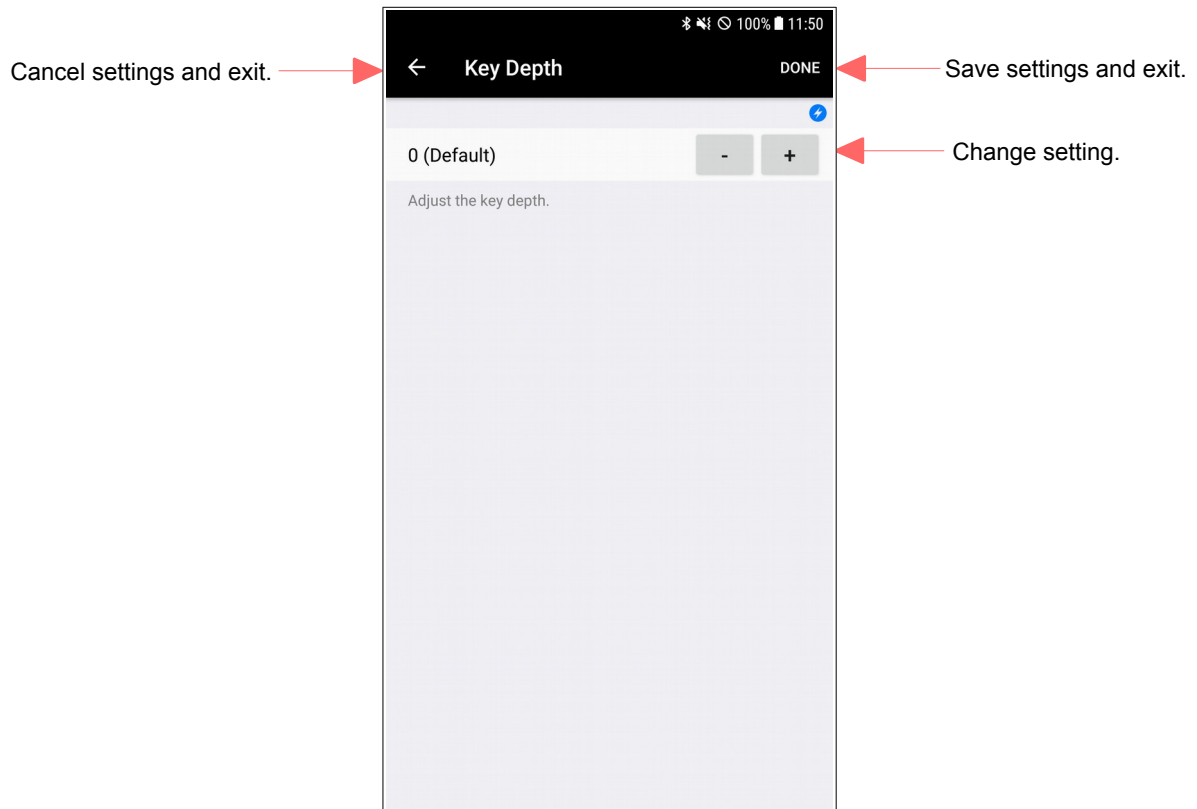

8.2.5. Note Repeat Limit

Adjust the number of the notes repeated by a key.

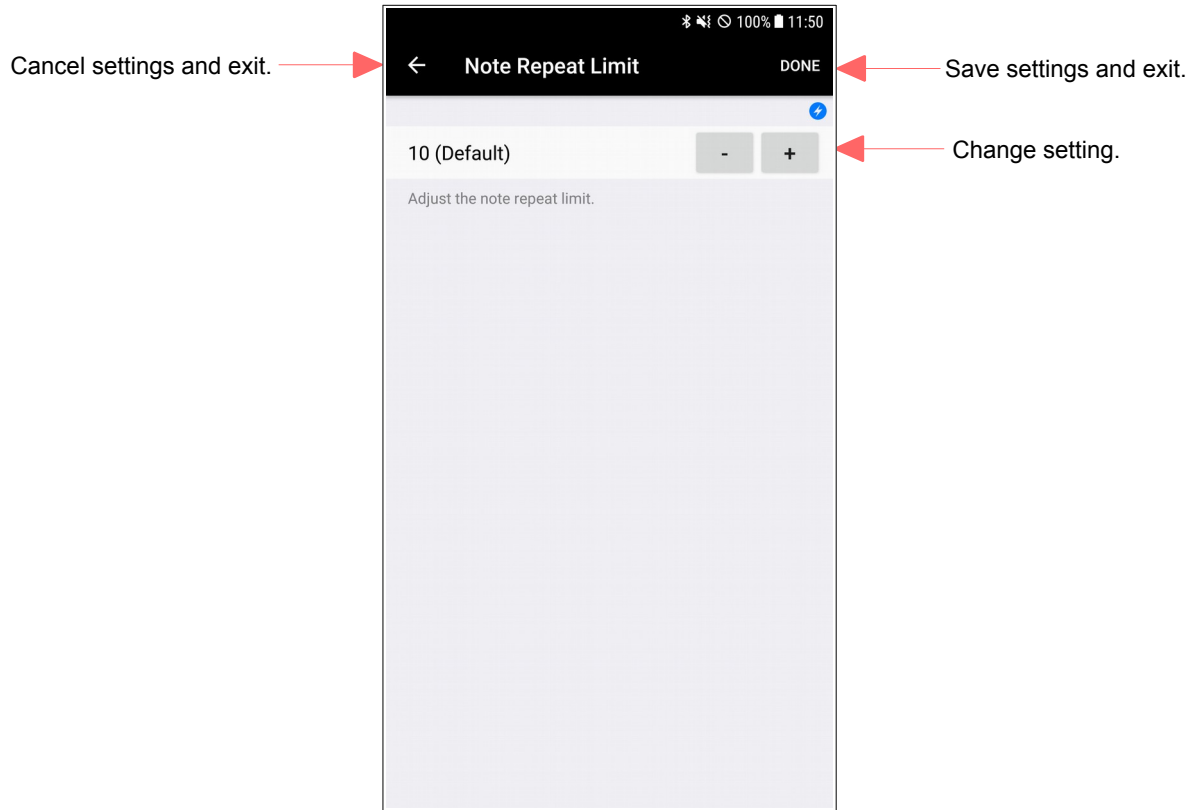

8.3. Pedal Position

Adjust the pedal detection position and damper pedal mode.

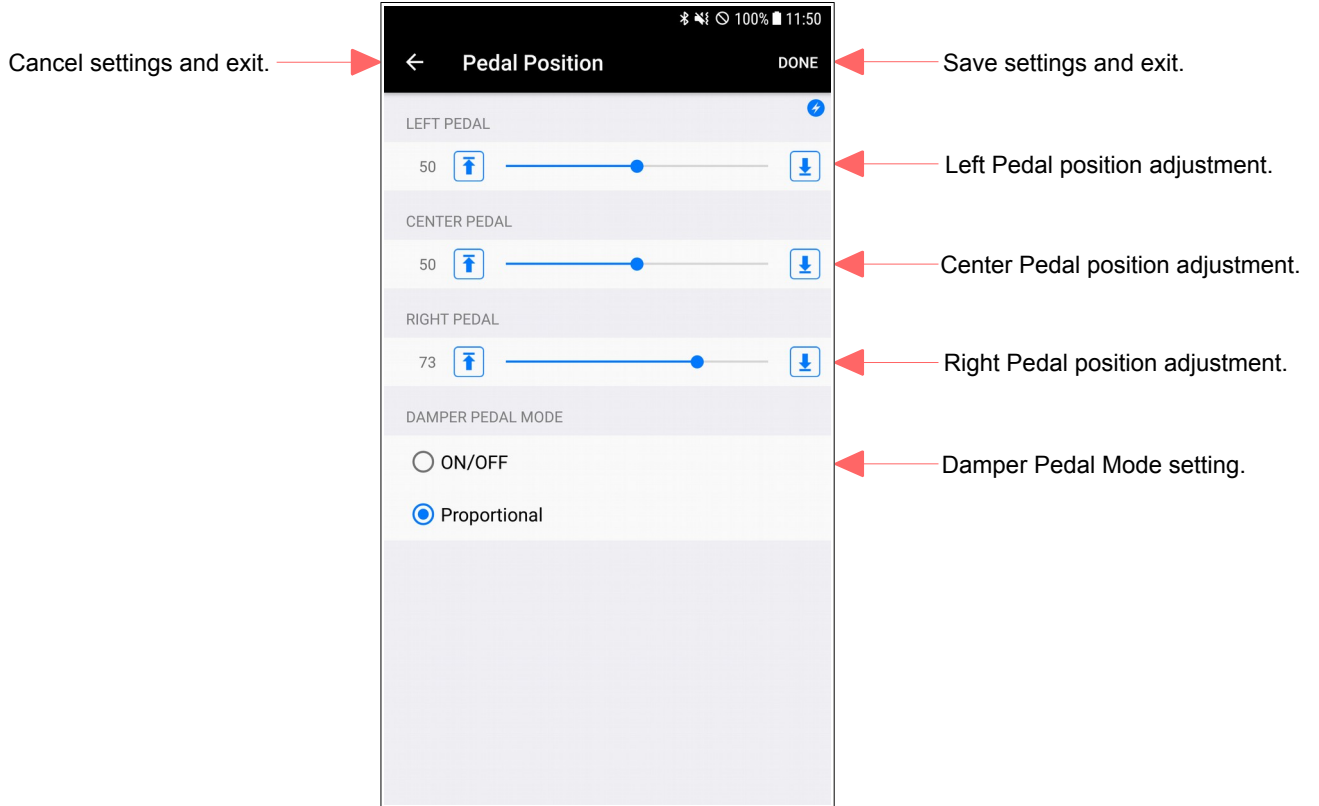

8.4. Tuning

Adjust the Tuning.

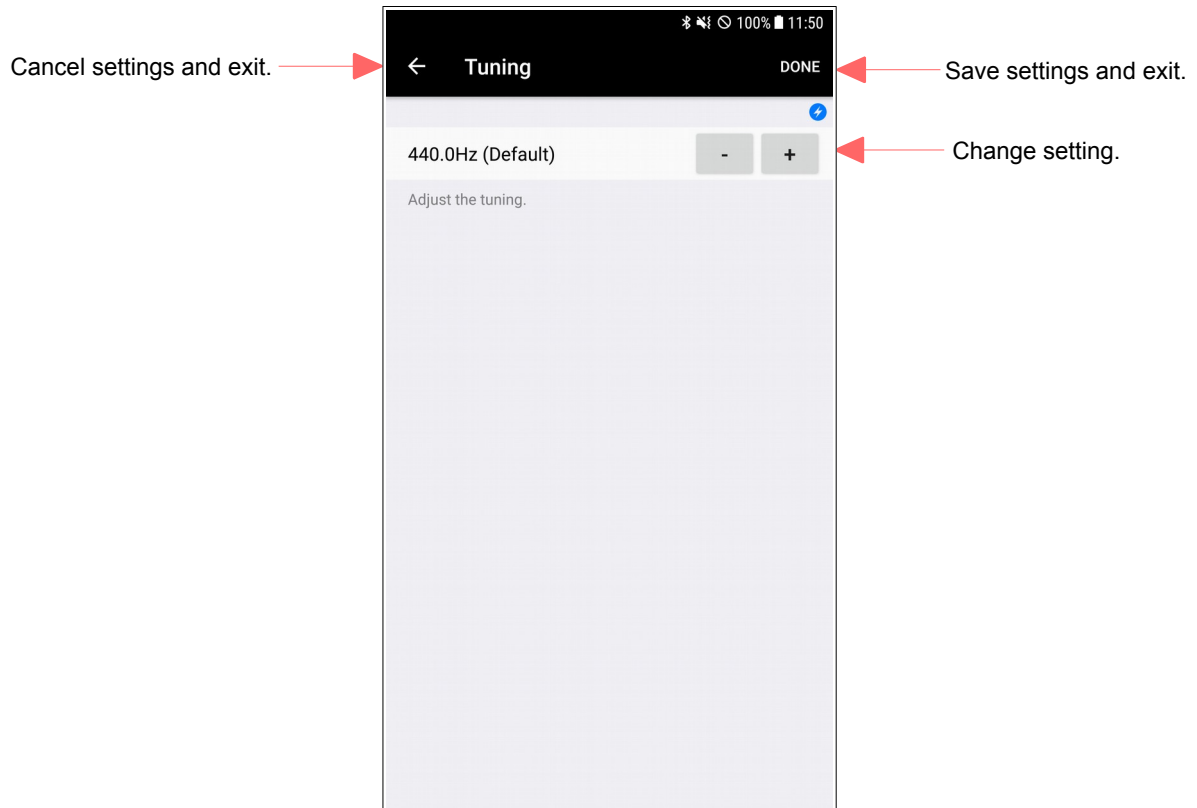

8.5. Tuning Curve

It is possible to edit a tuning curve.

The factory default setting is preset to AK-01's original tuning curve, but if you set it to custom on this screen, you can edit to your favorite tuning curve (flat curve immediately after switching to custom It is displayed).

The screenshot shows the 'Tuning Curve' app interface. At the top, there is a back arrow and the title 'Tuning Curve'. Below the title, there is a 'Custom' toggle switch which is turned on. Underneath, there are four buttons: 'Box Load', 'Box Save', 'File Load', and 'File Save'. The main area of the app is a graph showing a flat line at 0 on a scale from -40 to +40, with a piano keyboard at the bottom. Below the graph, there are two sliders: 'Key 1' and 'Cent 0.00'. Red arrows point from text labels to these various elements.

- Return to adjustments.
- Load the curve data from AK-01 control box.
- Save the edited curve data to AK-01 control box.
- When curve editing, the Custom is set ON.
- Save the edited curve data to file.
- Load the curve data from file.
- Key selection.
- Tuning adjustment.

8.6. Energy Saving

Displays the adjustment items related to the energy saving.

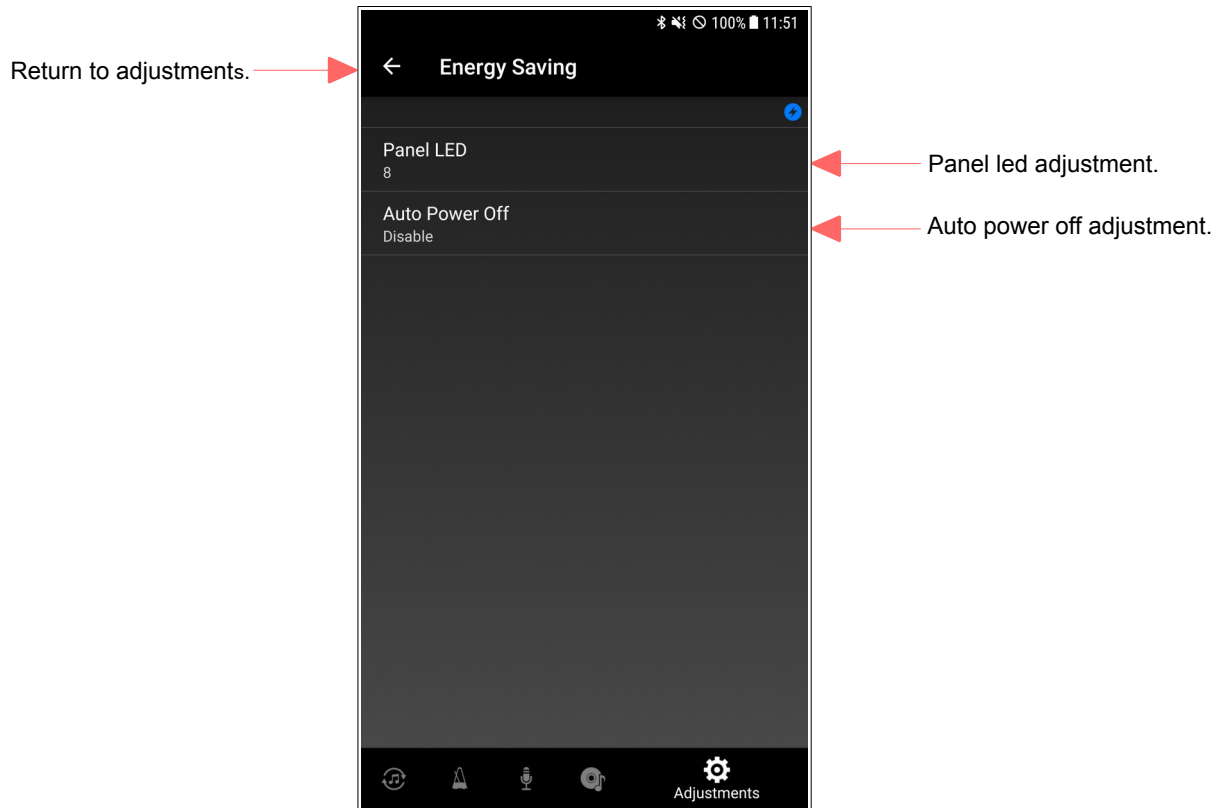

8.6.1. Panel LED

Adjust the Brightness of Panel LED.

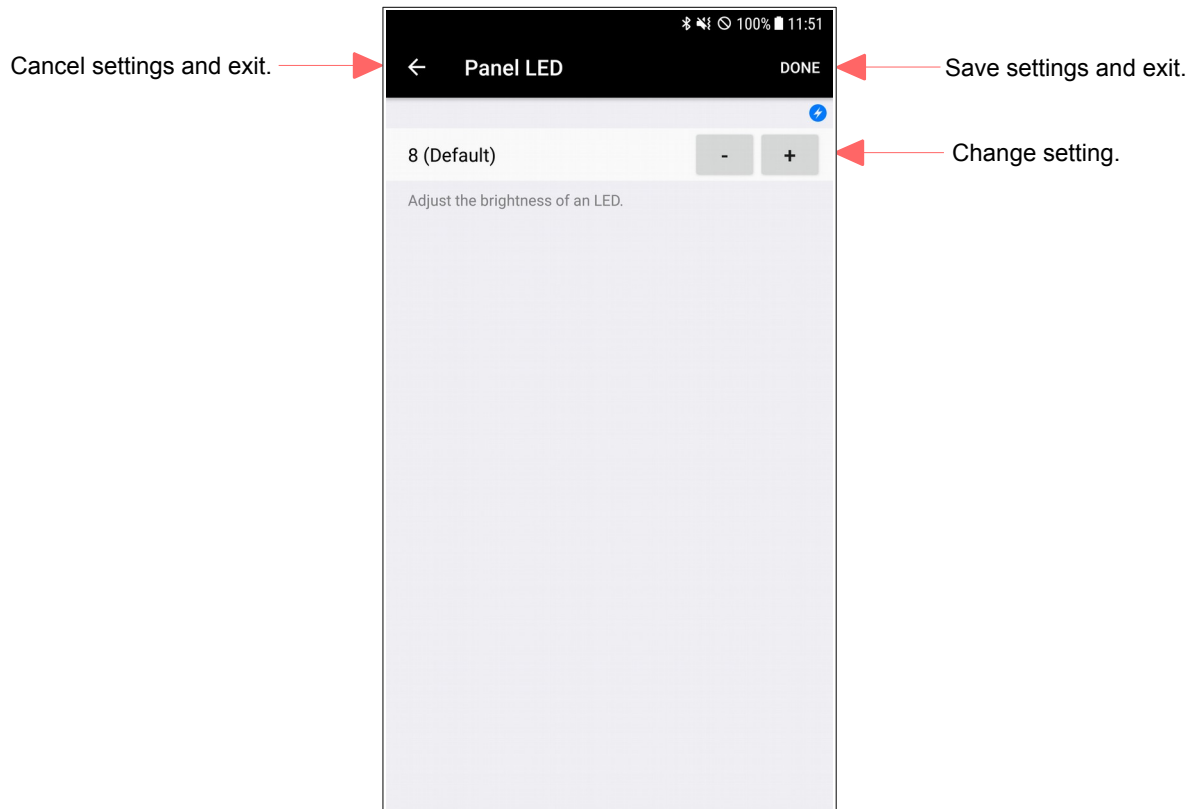

8.6.2. Auto Power Off

Set the auto power off of the AK-01 control box.

If the unplayed state exceeds the time set here, the power of the AK-01 control box is automatically turned off. When set to disable, auto power off does not work.

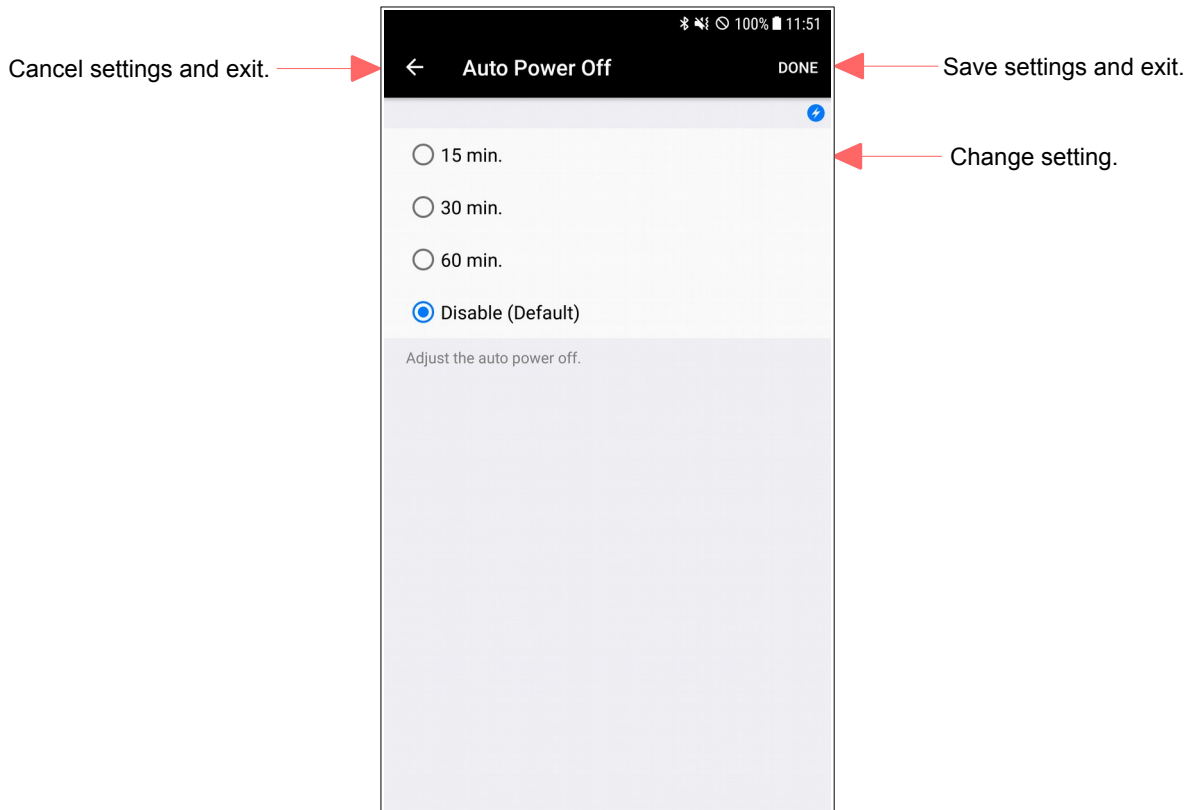

8.7. Factory Reset

Reset all the settings of your AK-01 control box to the factory default.

Note: the piano type and tuning curve will not be reset.

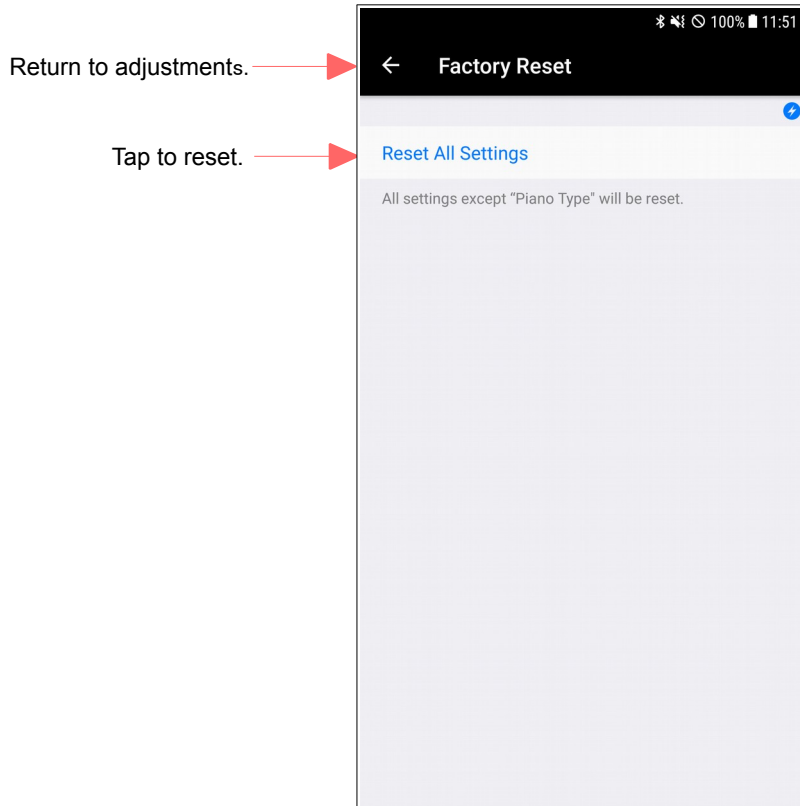

[NOTE]

Once the factory settings have been made, it is necessary to turn off the power of the AK-01 control box.

When the power is turned on again, the recording lamp and playback lamp of the AK-01 control box will flash alternately to indicate that the initial settings are required. Perform the initial setting according to the procedure of the initial setting in the instruction manual supplied with the main unit.

It is not possible to connect with ANYTIME AK-01 App until initialization is complete.

8.8. Info

Display the ANYTIME AK-01 app information.

Display the version of ANYTIME AK-01 app and AK-01 control box.

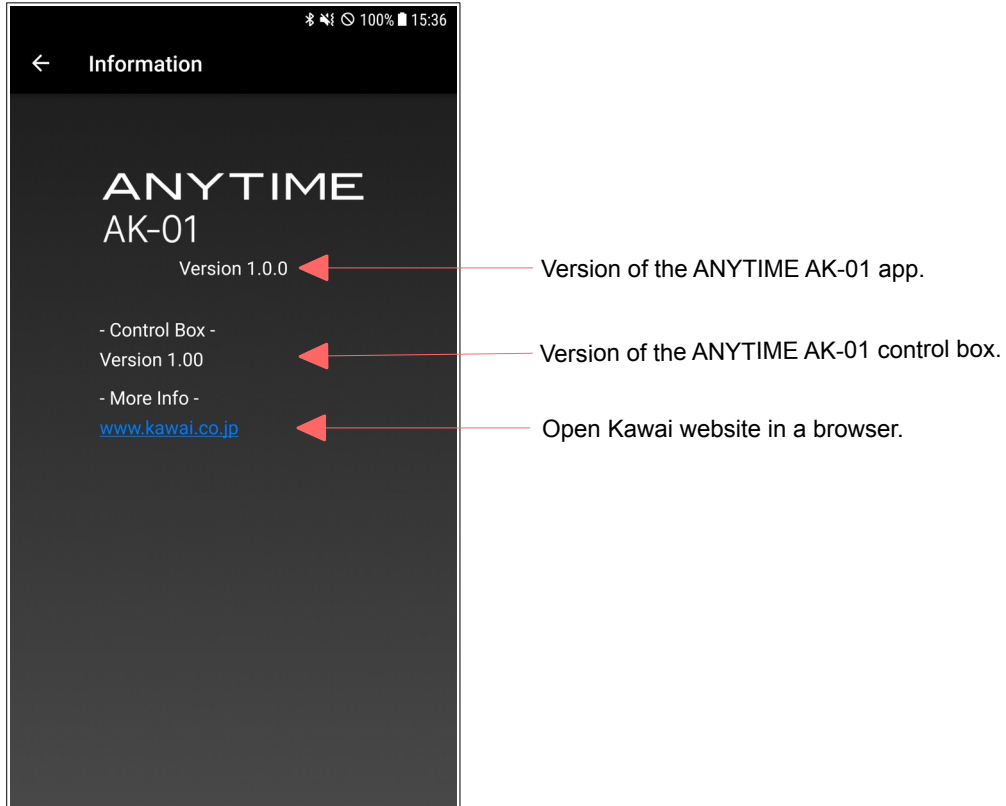

9. Troubleshooting

If the blue circle icon at the top of the screen of ANYTIME AK-01 App is not displayed, Bluetooth connection with the AK-01 control box has not been established.

If this is the case, please check the following points.

- Bluetooth connection can not be established if the Bluetooth setting on the sound screen of ANYTIME AK-01 App is not connected. Please tap Bluetooth settings and connect with AK-01 control box.
- If the REC lamp and the PLAY lamp of the AK-01 control box flash alternately, you can not connect to the Android. This blinking indicates that the initial setting is required. Perform the initial setting.

If the above problems do not exist, you may be able to improve it by executing the following items.

- Please turn off the power of AK-01 control box and turn it on again.
- Please turn off the Bluetooth settings on the Android and then on again.
- After forced termination of ANYTIME AK-01 App, please launch ANYTIME AK-01 App again.
- Please turn off the Android once and then turn it on again.
- If there are wireless devices in the vicinity, turn off the wireless devices in the vicinity.
- Please try to reduce the distance between the AK-01 control box and the Android.

Trademarks and Disclaimer

Android are registered trademarks of Google LLC.

Other product and company names are registered trademarks or trademarks of their respective owners.

The contents of this manual are subject to change without notice.

This manual may not be reproduced, modified, or reprinted in any form, in whole or in part, without permission.

We are not responsible for damages such as data loss with the use of this software.

© 2019 Nissin Electro Co., Ltd. All rights reserved.